

TECHNICAL PROCEDURE

Hotbar 2-2.5 Replacement Instructions

Applies to: 8/10-Series Treadmills

Enhanced Images: Pictures can be zoomed in to any level for detail. Use the standard zoom tools for your platform to zoom in.

Required Parts:

For 8/10-Series Treadmills:

- 715-4434-13 "KIT, ASSY, UPPER/LOWER, HOTBAR 2.5, SILVER"
- OR
- 715-4434-38 "KIT, ASSY, UPPER/LOWER, HOTBAR 2.5, GREY"

For 8G Stepmill:

- 711-7144 "KIT, ASSY, UPPER/LOWER, HOTBAR V2.5. SM"

Required Tools:

- 3mm Allen Key
- 4mm Allen Key
- #2 Phillips Screwdriver
- 13mm Socket
- Ratchet Wrench
- 12mm Open-Ended Wrench

For 8G hotbar replacement, please see page 11.

8TR(x) + 10TRX:

Please note what while the instructions show the 10-Series treadmill, unless otherwise noted, these steps are valid for the 8-Series treadmills.

For 8-Series Treadmill - Start at Step 3.

1. Use a 4mm allen key to remove the screw securing the left handrail grip.
2. Repeat Step 1 for the right side grip.

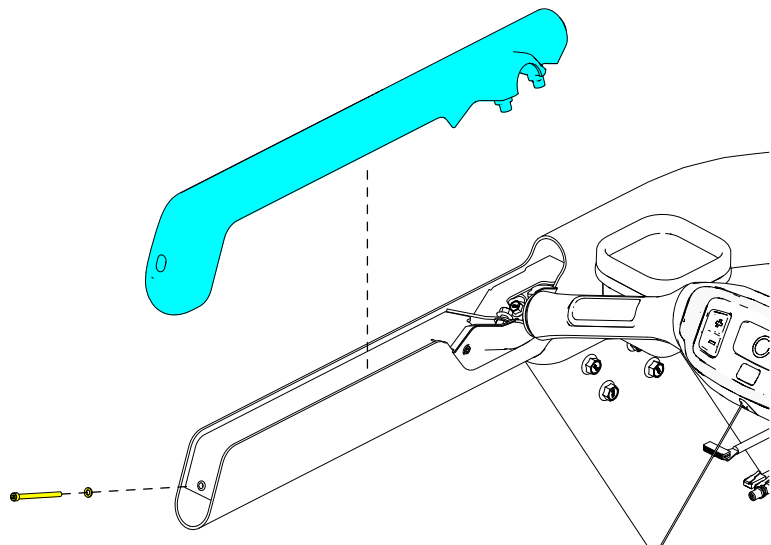

Fig. 1

TECHNICAL PROCEDURE

3. FOR 10-SERIES:

- Use a 4mm allen key to remove the four (4) screws securing the left hotbar side shroud.
- Repeat for the right side shroud.

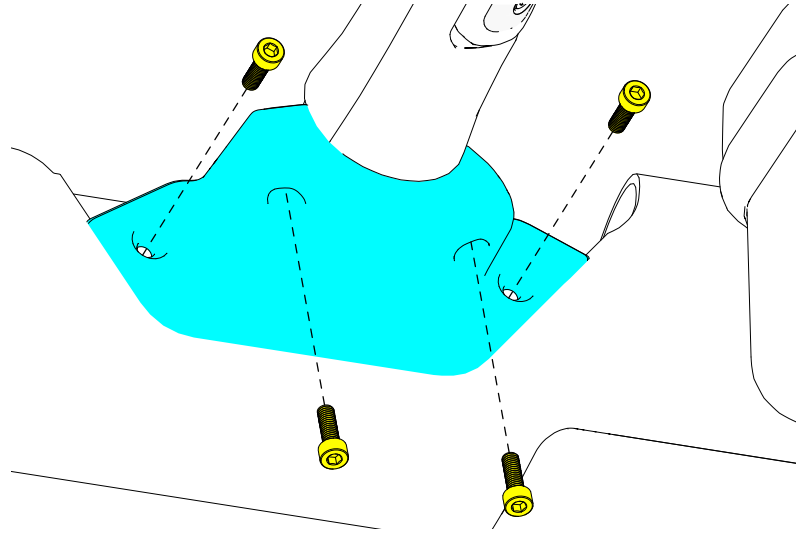

Fig. 2

FOR 8-SERIES:

- Use a #2 Phillips Screwdriver to remove the four (4) screws securing the upper and lower left side shrouds to the hotbar assembly, then remove the shrouds.
- Repeat for the right side shrouds.

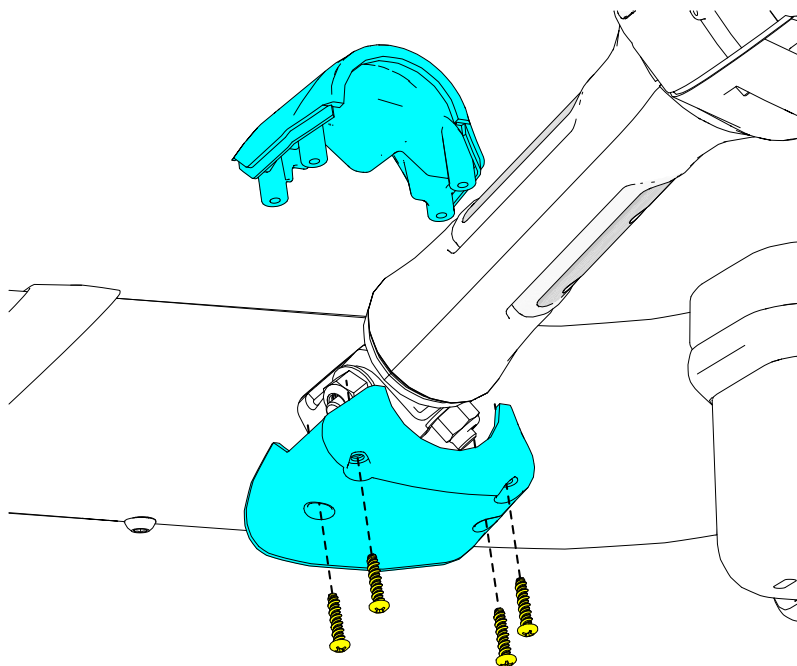

Fig. 3

TECHNICAL PROCEDURE

4. Use a 3mm allen key to remove the two (2) screws securing the left side front and back heart rate grips to the hotbar - **BE SURE TO DISCONNECT THE HEART RATE WIRES FROM THE GRIPS.**
5. After disconnecting the wires, remove the grips.
6. Repeat Steps 4+5 for the right side grips.

⚠ TECH TIP: Take a picture of the cables before removing them for reference during re-assembly.

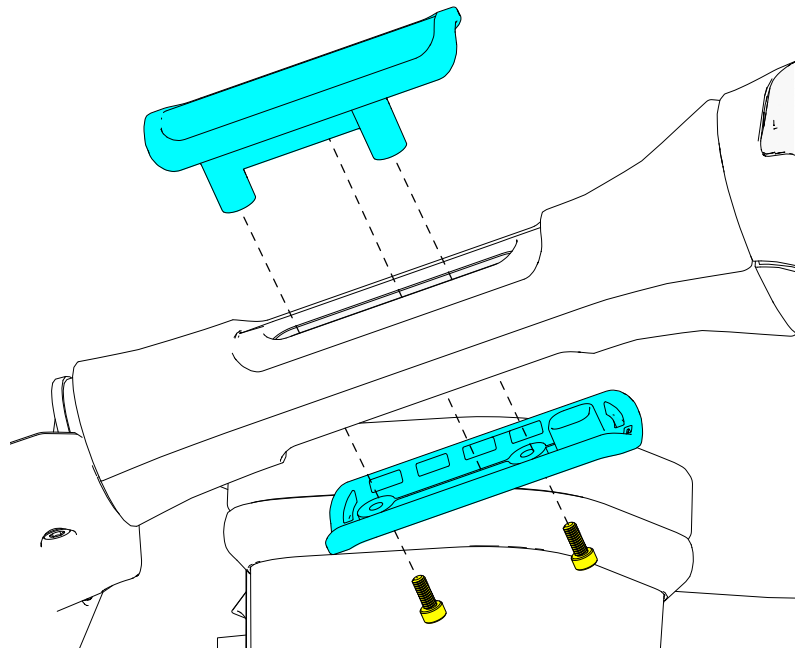

Fig. 4

7. Use a 4mm allen key to remove the eight (8) screws securing the front hotbar button plate to the hotbar assembly - **BE SURE TO DISCONNECT THE BUTTON PLATE CABLE.**
8. Remove the button plate.

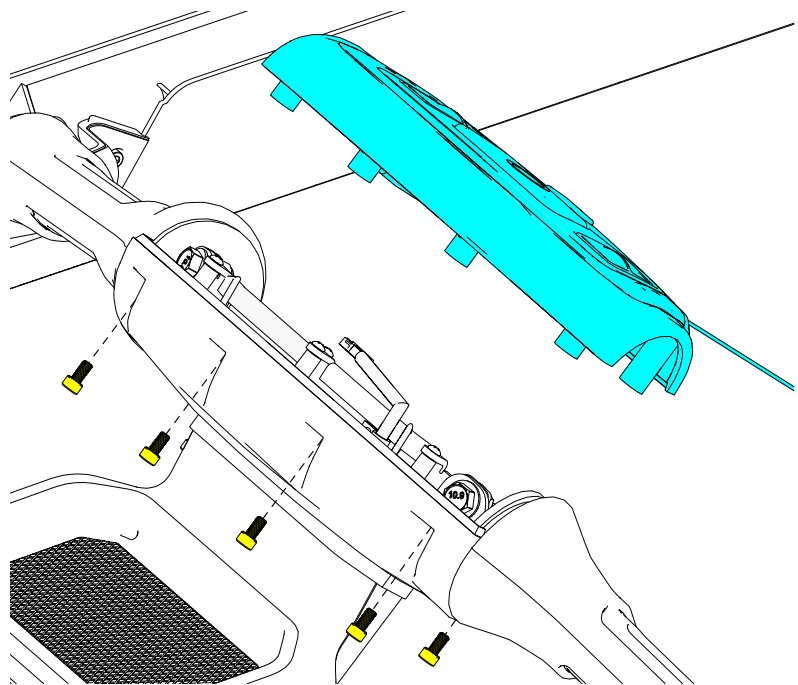

Fig. 5

TECHNICAL PROCEDURE

9. Use a #2 phillips screwdriver to remove the five (5) screws securing the rear hotbar plate to the hotbar assembly.

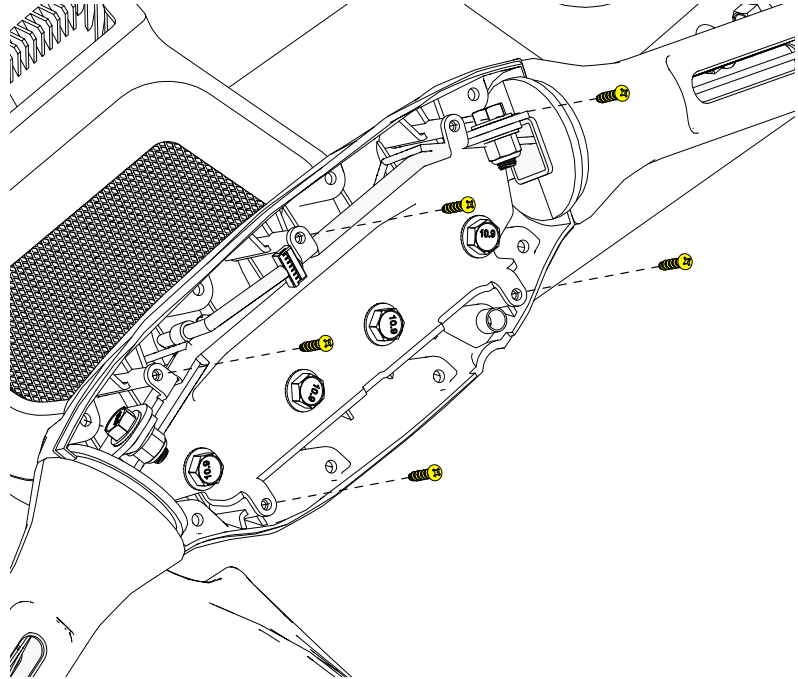

Fig. 6

10. Use a ratchet wrench with a 13mm socket to remove the two (2) hex head screws securing the hotbar assembly to the bracket bridge.

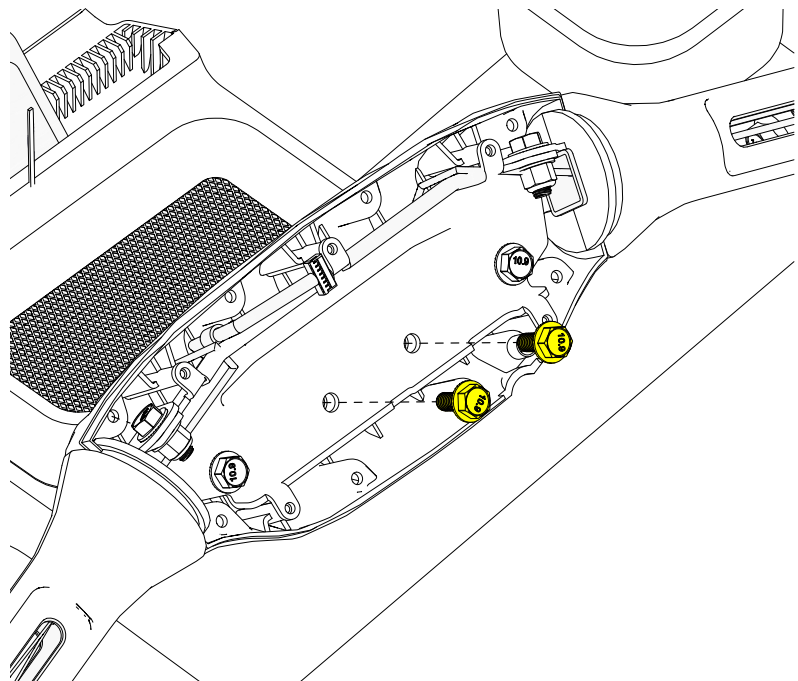

Fig. 7

TECHNICAL PROCEDURE

- 11.** Use a 12mm open-ended wrench and a ratchet wrench with a 13mm socket to remove the two (2) bolts and nuts securing the left side of the hotbar assembly to the top rail weldment.
- 12.** Repeat Step 11 for the hardware on the right side.

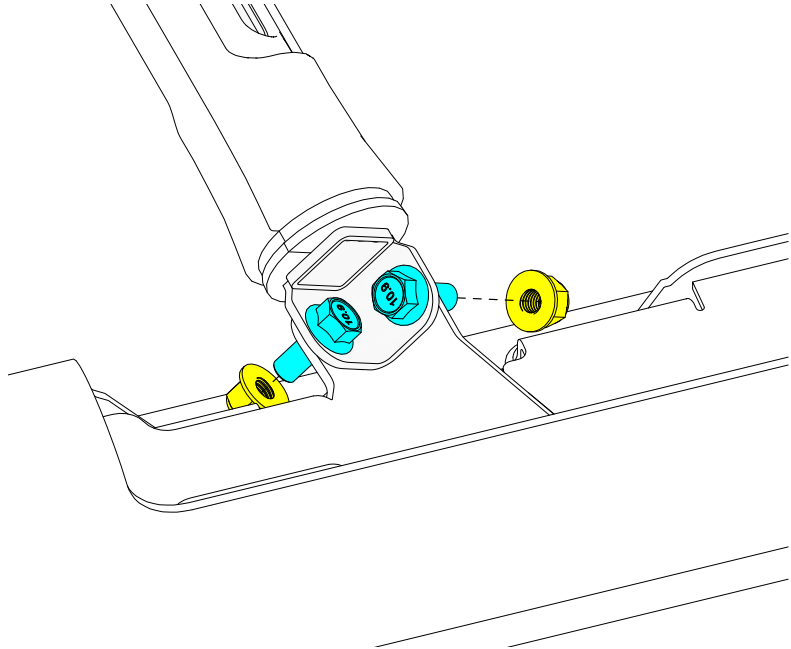

Fig. 8

- 13.** Remove the hotbar assembly from the top rail weldment, taking care not to damage the hotbar cable as the hotbar assembly is removed.

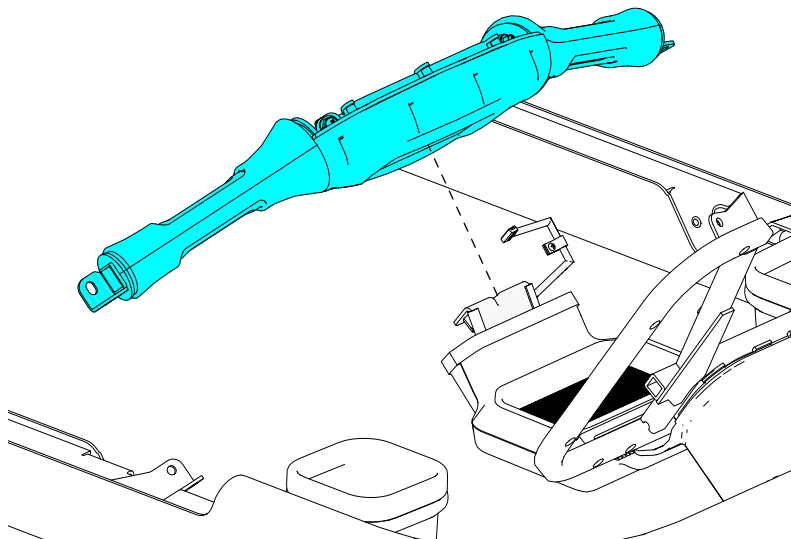

Fig. 9

TECHNICAL PROCEDURE

- 14.** Remove the rear hotbar plate from the hotbar assembly.

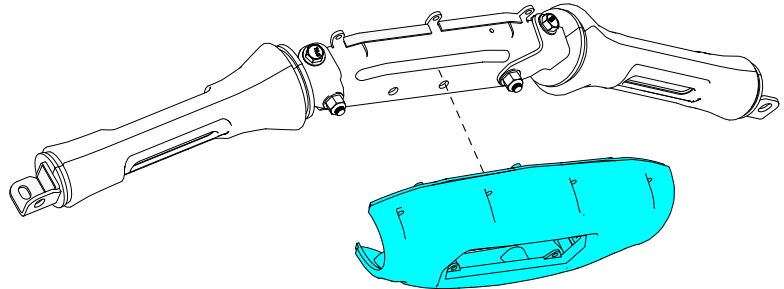

Fig. 10

- 15.** Use the screws removed in Step 9 to secure the new rear plate from 715-4434-XX.

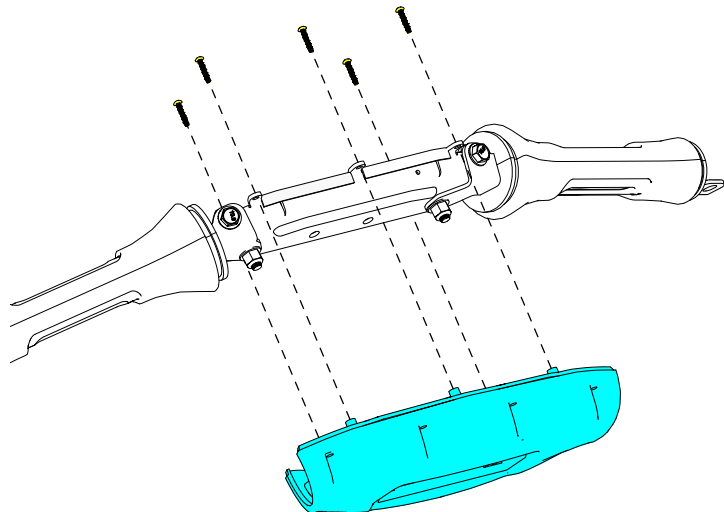

Fig. 11

TECHNICAL PROCEDURE

- 16.** Re-align the hotbar assembly with the new rear plate with the top rail weldment and bracket bridge - be sure to reinstall the hotbar cable.

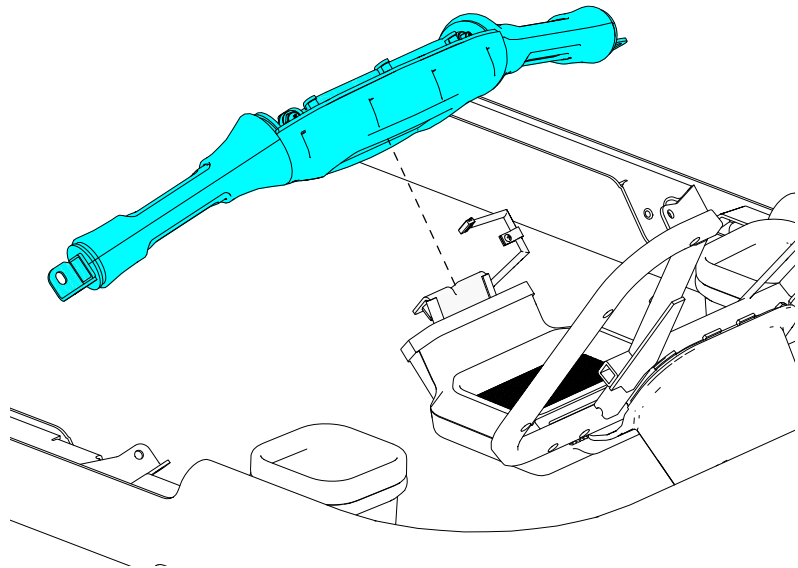

Fig. 12

- 17.** Install, **DO NOT FULLY TIGHTEN**, the two hex head screws removed in Step 10.

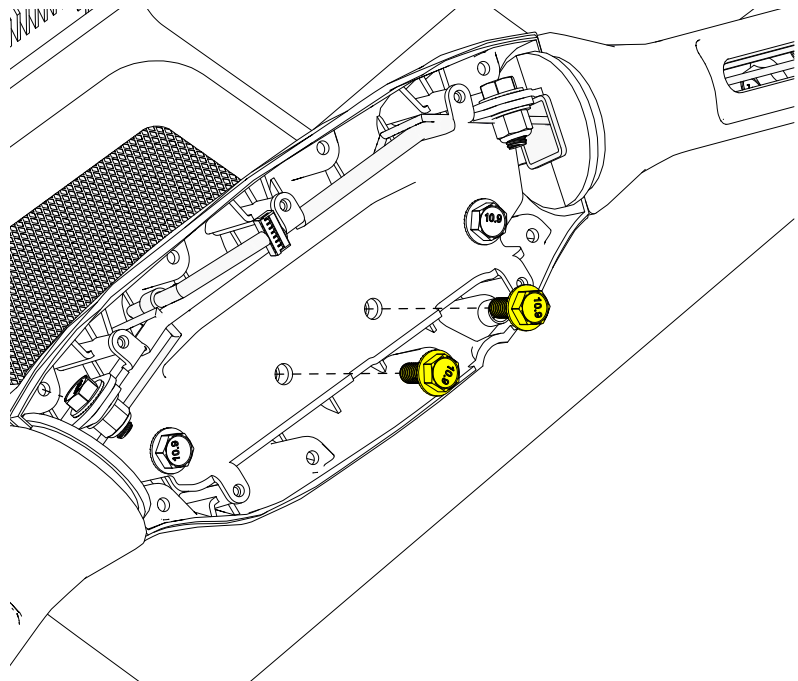

Fig. 13

TECHNICAL PROCEDURE

- 18.** Install the two (2) nuts and bolts removed in Step 11, **DO NOT FULLY TIGHTEN.**
- 19.** Repeat Step 18 for the other side, **DO NOT FULLY TIGHTEN..**
- 20.** Ensure that the hotbar assembly is properly aligned with the top rail weldment and the bracket bridge, then tighten the hardware in Steps 18-20.

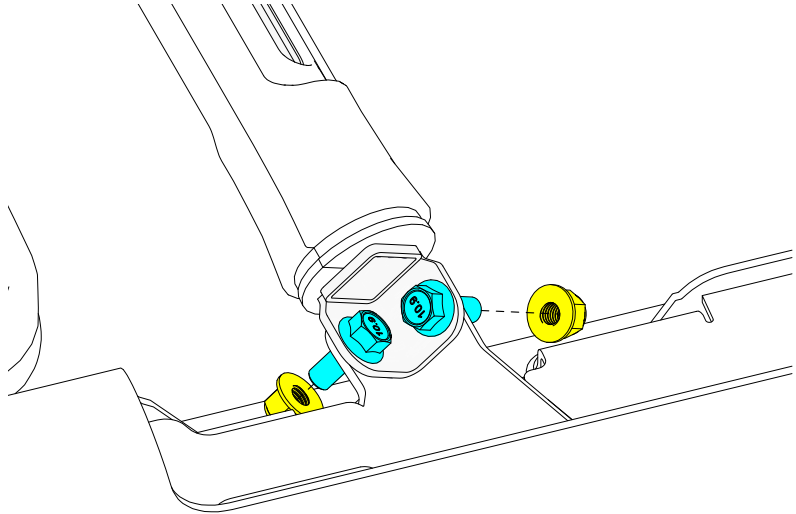

Fig. 14

- 21.** Connect the hotbar cable to the new front plate from 715-4434-XX, then secure the plate to the hotbar assembly using the screws removed in Step 7.

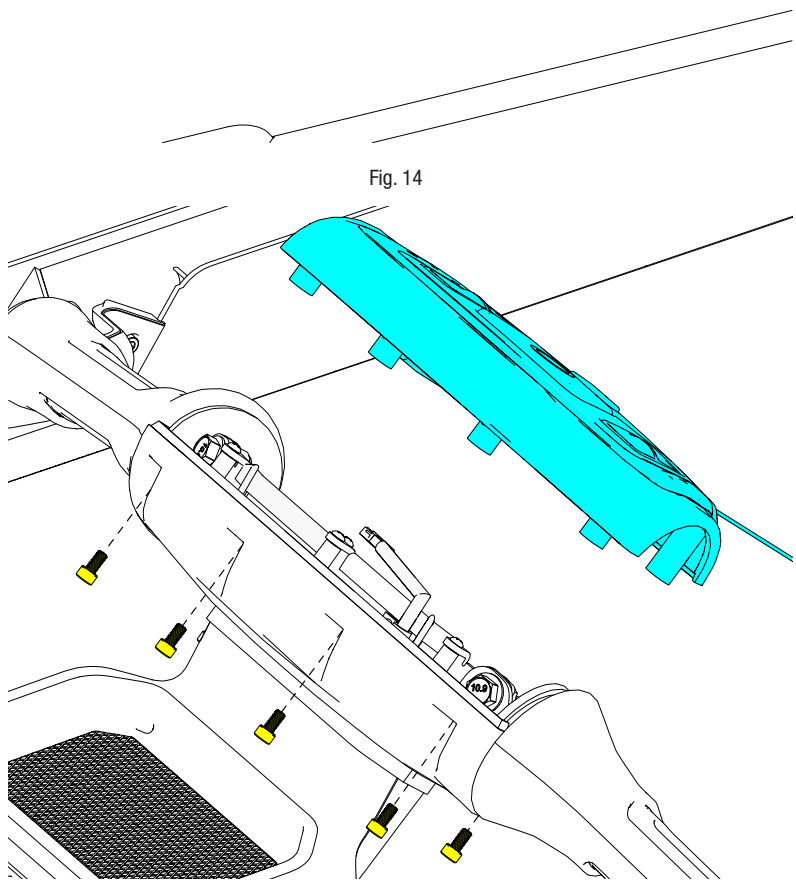

Fig. 15

TECHNICAL PROCEDURE

- 22.** Reinstall both the left and right, front and rear heart rate grips - be sure the reconnect the heart rate cables to the grips before installation.

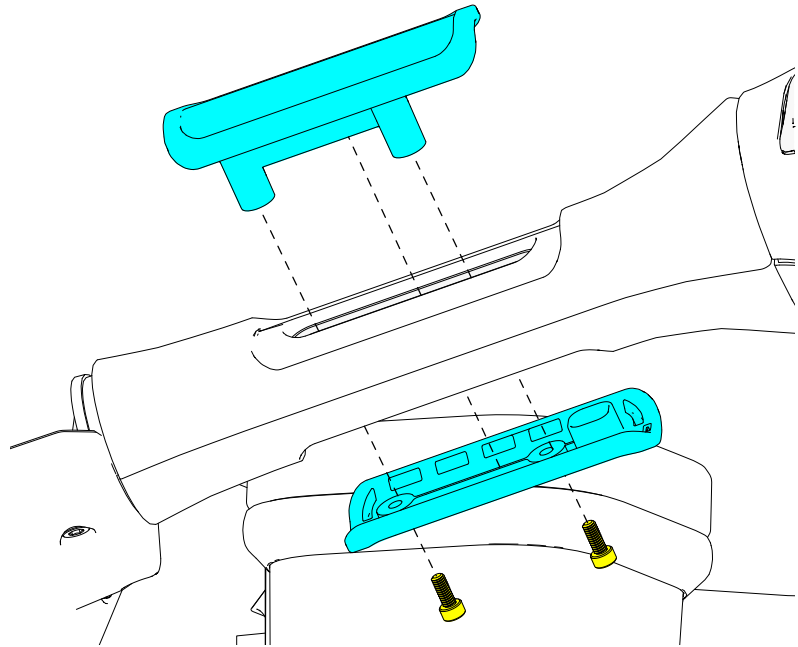

Fig. 16

- 23.** Reinstall the left and right hotbar side shroud(s) using the hardware removed in Step 3.

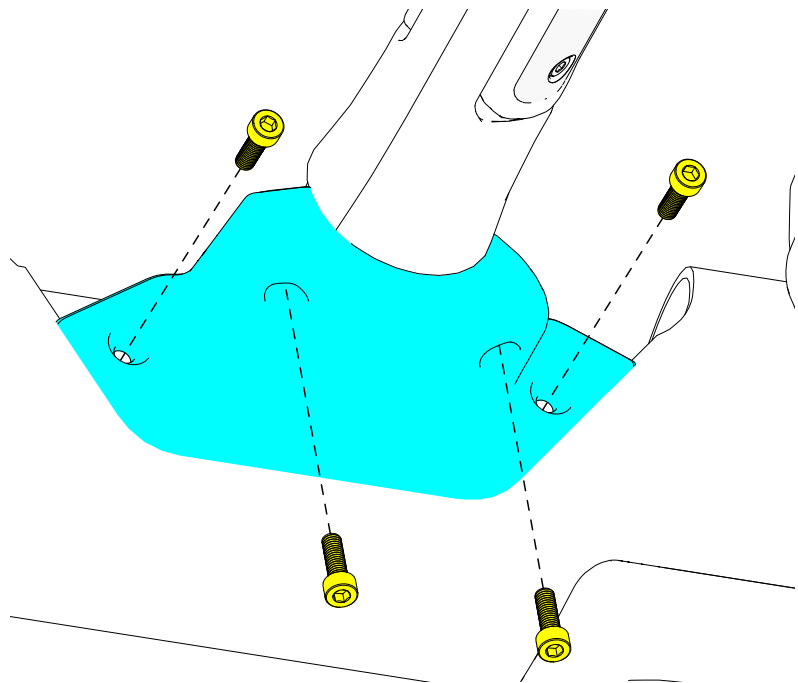

Fig. 17

TECHNICAL PROCEDURE

For 10-Series:

24. Reinstall the left and right top grips.

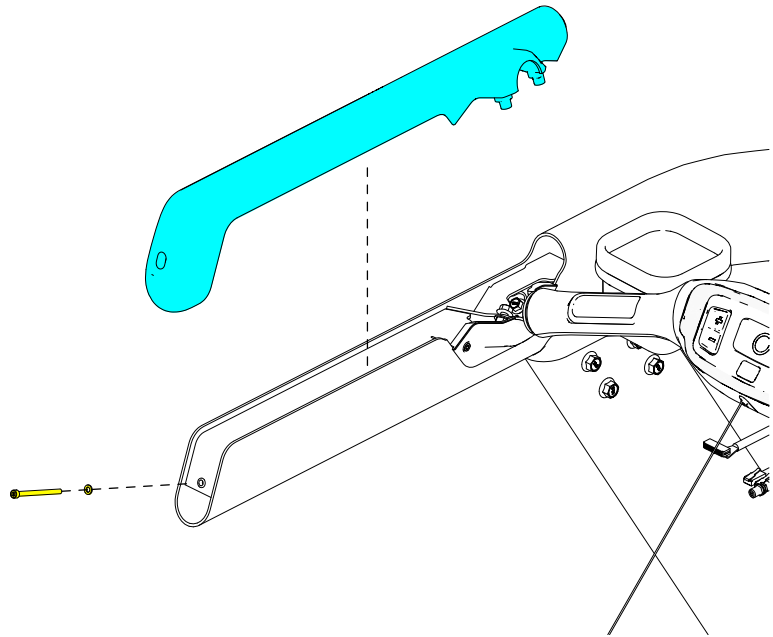



Fig. 18

TECHNICAL PROCEDURE

8G Stepmill

1. Use a 3mm allen key to remove the two (2) screws securing the left side front and back heart rate grips to the hotbar - **BE SURE TO DISCONNECT THE HEART RATE WIRES FROM THE GRIPS.**
2. After disconnecting the wires, remove the grips.
3. Repeat Steps 1+2 for the right side grips.

 **TECH TIP:** Take a picture of the cables before removing them for reference during re-assembly.

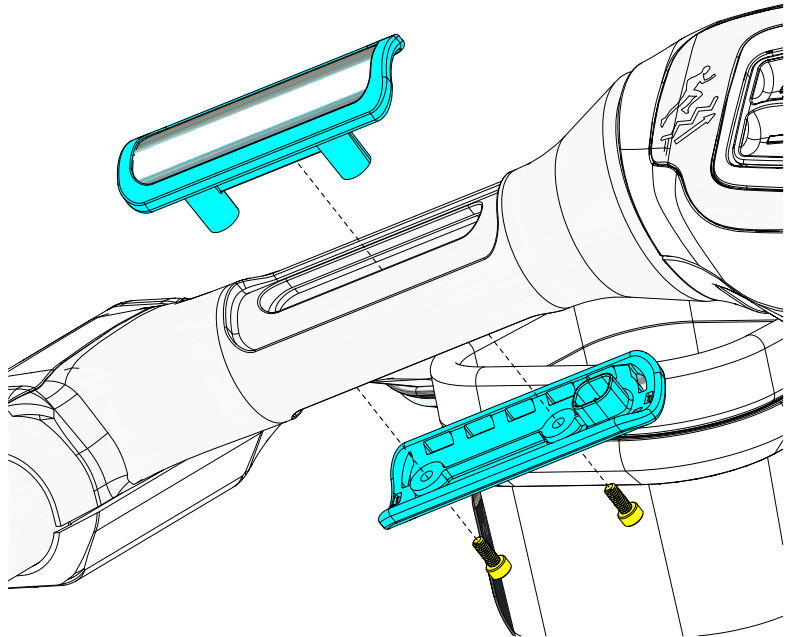

Fig. 19

4. Use a 3mm allen key to remove the two (2) screws and washers securing the left side hotbar assembly to the handrails, then remove the handle cap.
5. Repeat Step 4 for the right side.

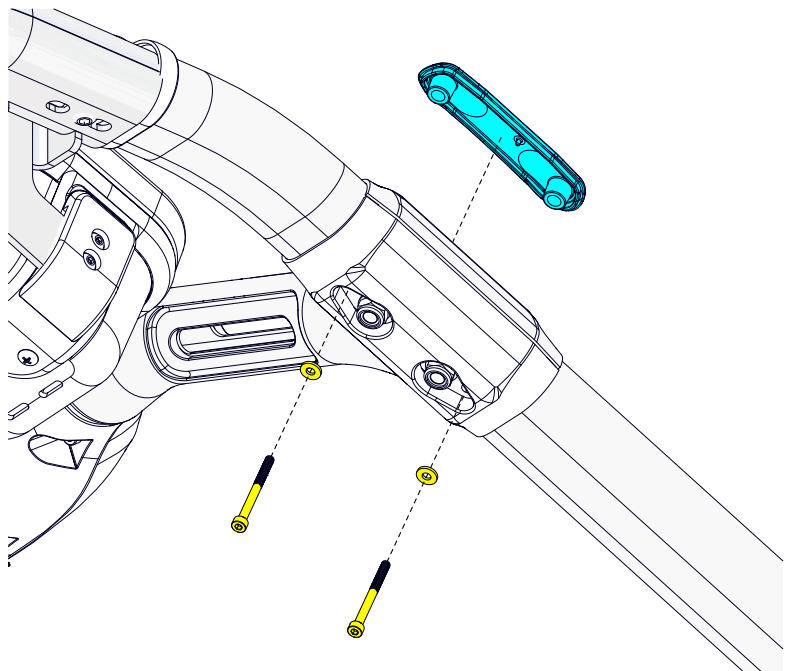

Fig. 20

TECHNICAL PROCEDURE

6. Use a 13mm open-ended wrench and a ratchet wrench with a 6mm allen socket to remove the two (2) socket head bolts and nuts, and the four (4) washers securing the left hotbar assembly to the handrails.
7. Repeat Step 6 for the right side.

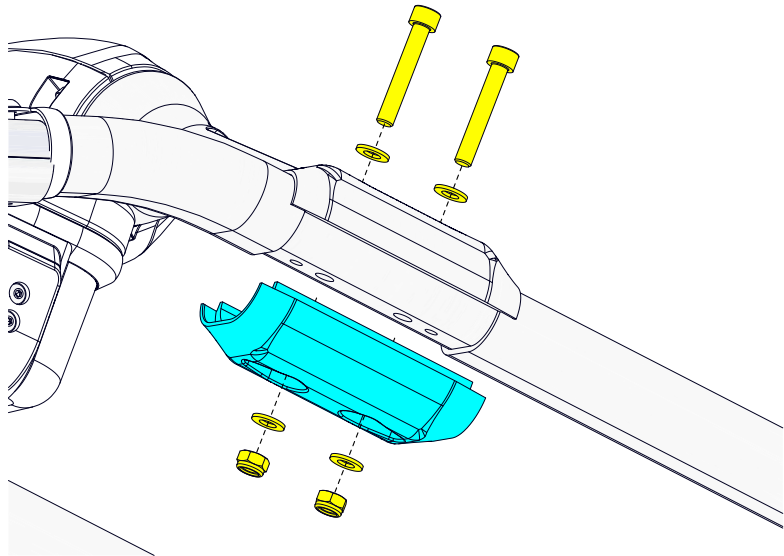

Fig. 21

8. Use a 4mm allen key to remove the eight (8) screws securing the front button plate to the hotbar assembly, then remove the plate - **BE SURE TO DISCONNECT THE BUTTON PLATE CABLE.**

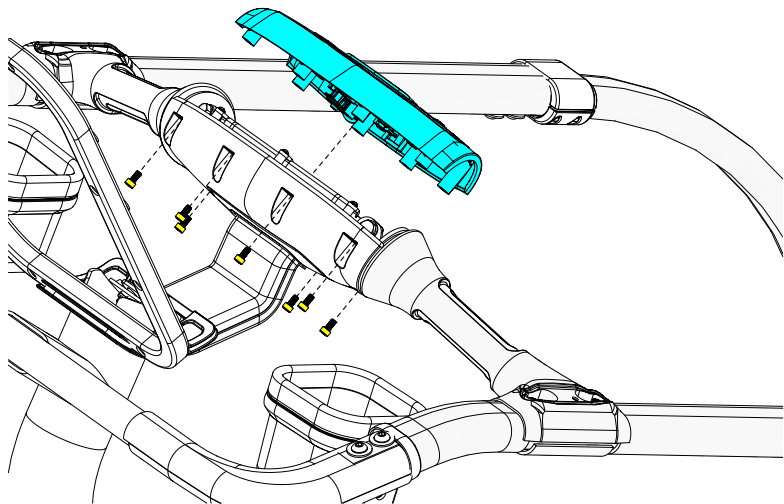

Fig. 22

TECHNICAL PROCEDURE

9. Use a #2 phillips screwdriver to remove the five (5) screws securing the rear hotbar plate to the hotbar assembly.

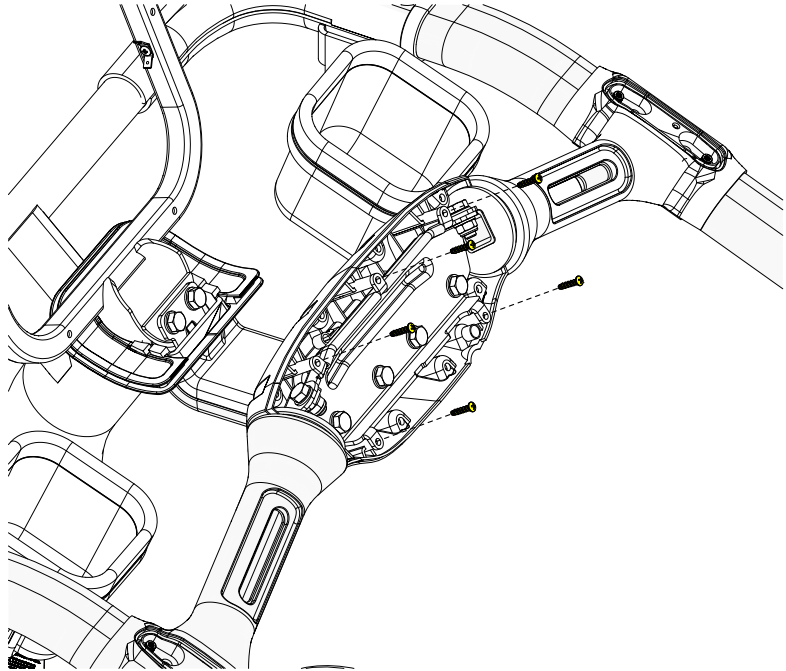

Fig. 23

10. Use a 4mm allen key to remove the four (4) screws securing the bridge bottom cover, then remove the cover.

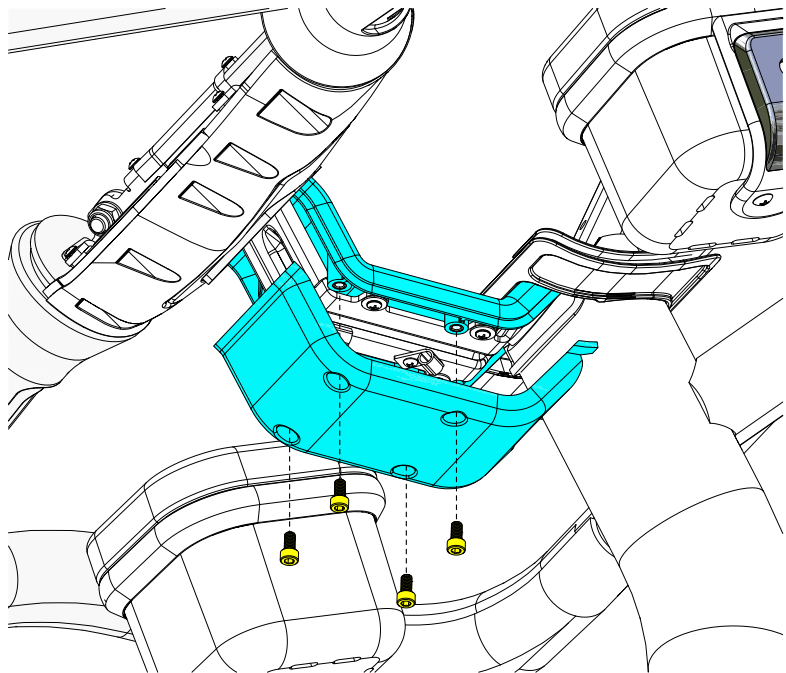

Fig. 24

TECHNICAL PROCEDURE

- 11.** Use a #2 phillips screwdriver to remove the four (4) screws and washers securing the bridge top cover to the bridge, then remove the cover.

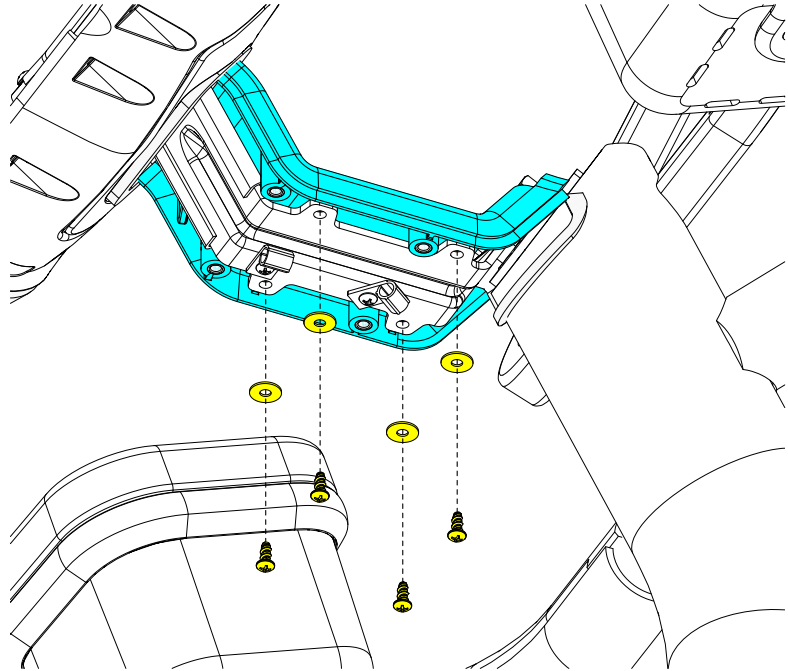

Fig. 25

- 12.** With the bridge covers removed, slide the rear plate down the bridge to access the nuts on the backside of the hotbar assembly.
- 13.** Use a 13mm open-ended wrench and a ratchet wrench with a 13mm socket to remove the two (2) bolts and nuts, and four (washers) securing the hotbar assembly to the bridge.

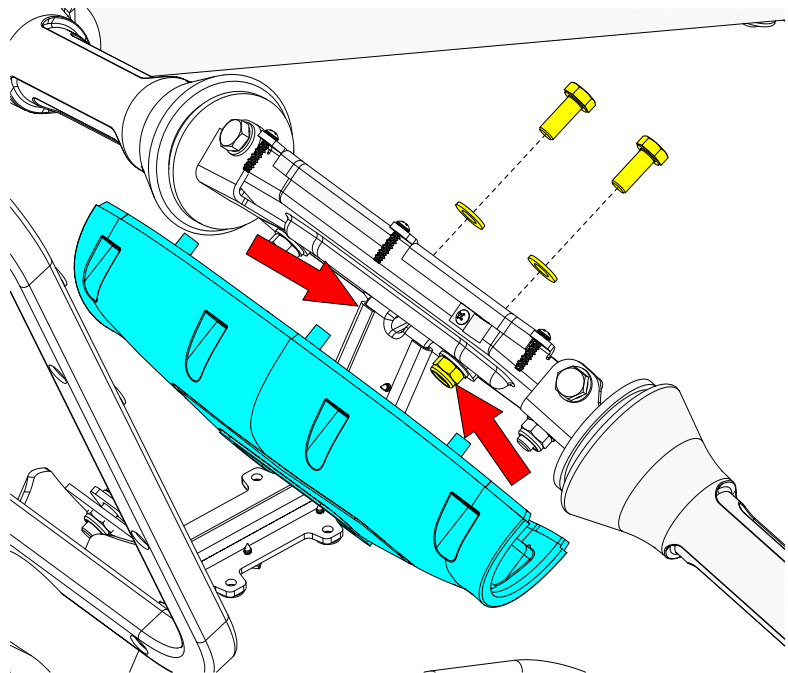

Fig. 26

TECHNICAL PROCEDURE

- 14.** Remove the hotbar assembly from the bridge and handrails.

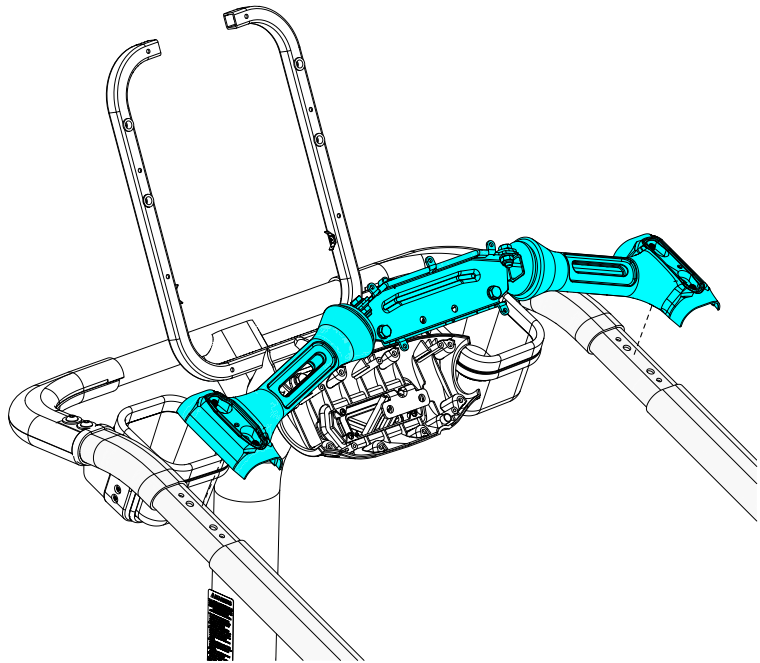

Fig. 27

- 15.** Remove the rear hotbar plate from the bridge and slide the new rear plate from 715-4434-XX onto the bridge.
- 16.** Follow Steps 14-1 to reassemble the hotbar assembly, being sure to replace the old front button plate in Step 8 with the new front plate from 715-4434-XX,

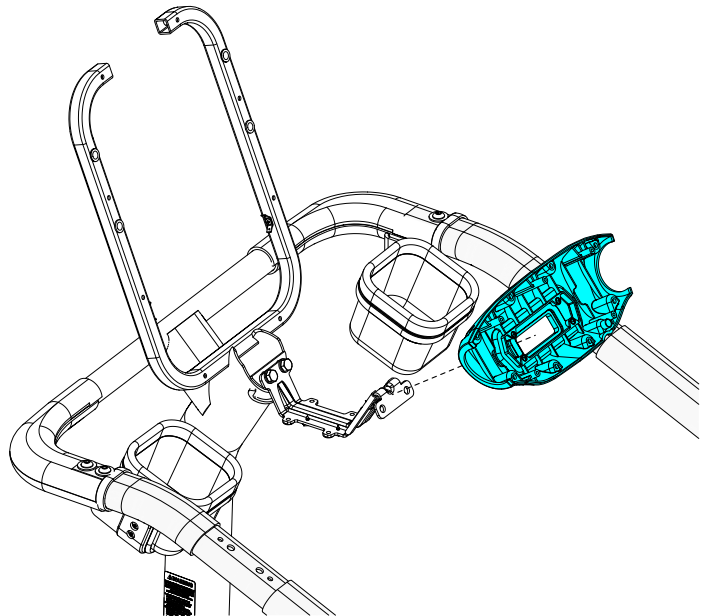

Fig. 28